



# Switch & Load Junction Box 16A

To fit 1.0mm<sup>2</sup> – 1.5mm<sup>2</sup>  
Twin & Earth solid core cable

- Internal 3 plate wiring configuration.
- Compact - Fits through 32mm hole.
- Maintenance free.
- No earth sleeving required.
- Lightning fast Quickwire™ push in technology.



PART NUMBER	QSL34	
RATING	250V~ 16A (Overcurrent protection limited to 16A)	
CONDUCTOR SIZE	1.0mm <sup>2</sup> – 1.5mm <sup>2</sup> Twin & Earth CPC Cable (6242Y or 6242B), Solid cores (Class 1)	
DIMENSIONS	23mm x 31mm x 84mm	
IP RATING	IP30	
STANDARDS	BS EN 60670-22 BS 5733-MF	
MOUNTING CLAMP	Compatible with Quickwire mounting clamp part number: QMC	

## CABLE PREPARATION

Cut and strip the 1.0mm<sup>2</sup> / 1.5mm<sup>2</sup> solid core, flat twin and earth cable as shown below:

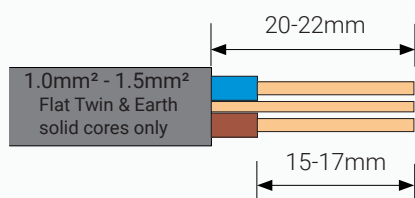

## INSTALLATION

Orientate and align pre-cut cable and insert into appropriate cable entry point. Each wire should guide itself into the correct terminal. Push cable until there is resistance.

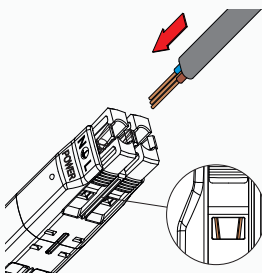

Check there is a sufficient length of outer cable sheath available for clamping (fig.1) and that an unbroken length of conductor occupies the full extent of the window (fig.2).

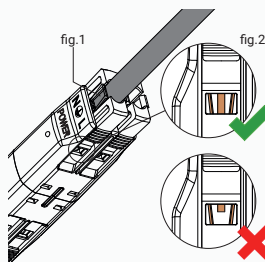

Push cable until it snaps into place. Repeat process for additional cables. Push in any unused cable entries.

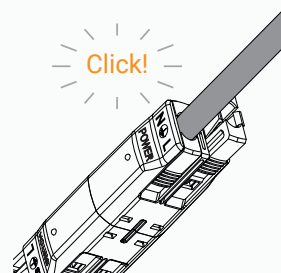

## SURFACE MOUNTING

If required the Quickwire can be fitted onto a surface using the Quickwire mounting clip. (Part no. QMC). **Warning: Do not cover**

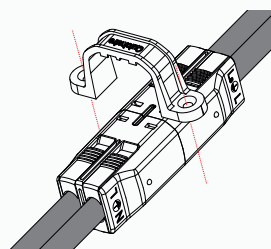

## CABLE REMOVAL

Mount removal tool (part no. QRT). Place thumb on thumb grip and using other hand, squeeze side arms so they locate beneath the snaps. Push forward.

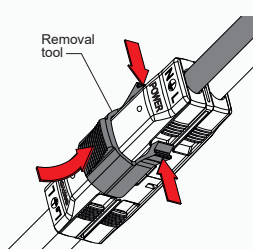

Patent no. PCT/GB2016/053627  
Reg.Design. 6004582

This product is designed for lighting installations only. Overcurrent protection is limited to 16A max.  
**Circuit to be protected by 16A MCB max.**

This product should be installed by a qualified electrician, ensuring the installation complies to the current IET wiring regulations. Switch off mains supply before commencing any electrical work.



+44 (0)1183 840025 | [Info@quickwire.co.uk](mailto:Info@quickwire.co.uk) | [www.quickwire.co.uk](http://www.quickwire.co.uk)

Quickwire Limited, Ruscombe Business Park, Ruscombe Lane, Twyford, Berkshire RG10 9JW, UK

A flexconnectors Company

# Quickwire

## 2 Way Splitter

16A

To fit 1.0mm<sup>2</sup> – 1.5mm<sup>2</sup>  
Twin & Earth solid core cable

- Maintenance free.
- Compact - Fits through 24mm hole.
- No earth sleeving required.
- Easily extend/repair a cable run.
- Lightning fast Quickwire™ push in technology.



PART NUMBER	QSP32	
RATING	250V~ 16A (Overcurrent protection limited to 16A)	
CONDUCTOR SIZE	1.0mm <sup>2</sup> – 1.5mm <sup>2</sup> Twin & Earth CPC Cable (6242Y or 6242B), Solid cores (Class 1)	
DIMENSIONS	23mm x 16mm x 84mm	
IP RATING	IP30	
STANDARDS	BS EN 60670-22 BS 5733-MF	
MOUNTING CLAMP	Compatible with Quickwire mounting clamp: QMC_TB	

### CABLE PREPARATION

Cut and strip the 2.5mm<sup>2</sup> solid core, flat twin and earth cable as shown below:

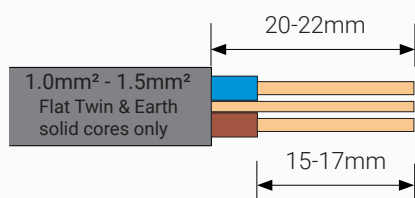

### INSTALLATION

Orientate and align pre-cut cable and insert into appropriate cable entry point. Each wire should guide itself into the correct terminal. Push cable until there is resistance.

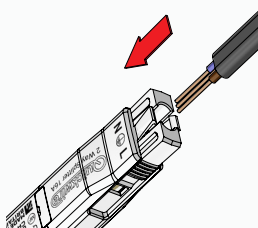

Check there is a sufficient length of outer cable sheath available for clamping.(fig.1) and that an unbroken length of conductor occupies the full extent of the window (fig.2).

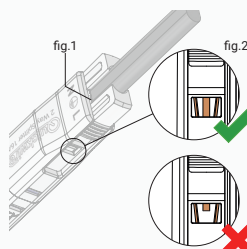

Push cable until it snaps into place. Repeat process for additional cables. Push in any unused cable entries.

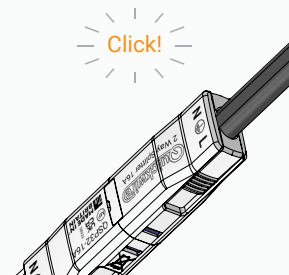

### SURFACE MOUNTING

If required the Quickwire can be fitted onto a surface using the Quickwire mounting clip. (Part no. QMC\_TB). **Warning: Do not cover**

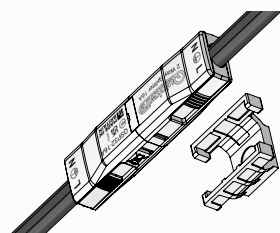

### CABLE REMOVAL

Mount removal tool (part no. QRT). Place thumb on thumb grip and using other hand, squeeze side arms so they locate beneath the snaps. Push forward.

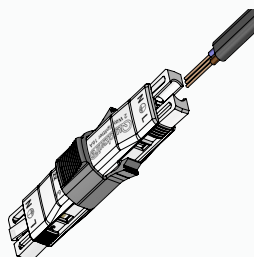

Patent no. PCT/GB2016/053627  
Reg.Design. 6004582

This product should be installed by a qualified electrician, ensuring the installation complies to the current IET wiring regulations. Switch off mains supply before commencing any electrical work.



+44 (0)1183 840025 | [Info@quickwire.co.uk](mailto:Info@quickwire.co.uk) | [www.quickwire.co.uk](http://www.quickwire.co.uk)

Quickwire Limited, Ruscombe Business Park, Ruscombe Lane, Twyford, Berkshire RG10 9JW, UK

A flexconnectors Company

# Quickwire

## 4 way splitter 16A

To fit 1.0mm<sup>2</sup> – 1.5mm<sup>2</sup>  
Twin & Earth solid core cable

- Lightning fast Quickwire™ push in technology
- Maintenance free.
- Compact - Fits through 30mm hole.
- No earth sleeving required.



PART NUMBER	QSP34	
RATING	250V~ 16A (Overcurrent protection limited to 16A)	
CONDUCTOR SIZE	1.0mm <sup>2</sup> – 1.5mm <sup>2</sup> Twin & Earth CPC Cable (6242Y or 6242B), Solid cores (Class 1)	
DIMENSIONS	23mm x 24mm x 84mm	
IP RATING	IP30	
STANDARDS	BS EN 60670-22 BS 5733-MF	
MOUNTING CLAMP	Compatible with Quickwire mounting clamp: QMC_TB	

### CABLE PREPARATION

Cut and strip the 1.0mm<sup>2</sup> / 1.5mm<sup>2</sup> solid core, flat twin and earth cable as shown below:

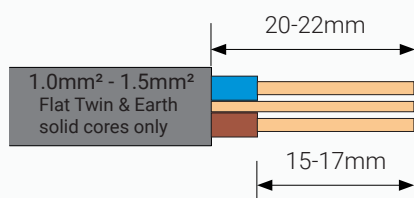

### INSTALLATION

Orientate and align pre-cut cable and insert into appropriate cable entry point. Each wire should guide itself into the correct terminal. Push cable until there is resistance.

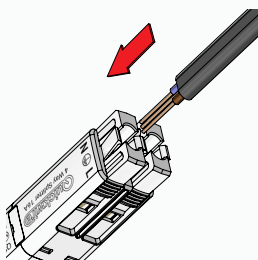

Check there is a sufficient length of outer cable sheath available for clamping (fig.1) and that an unbroken length of conductor occupies the full extent of the window (fig.2).

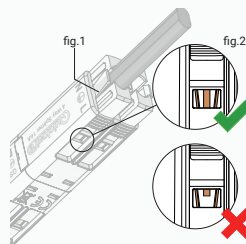

Push cable until it snaps into place. Repeat process for additional cables. Push in any unused cable entries.

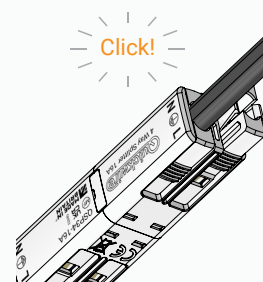

### SURFACE MOUNTING

If required the Quickwire can be fitted onto a surface using the Quickwire mounting clip. (Part no. QMC\_TB). **Warning: Do not cover**

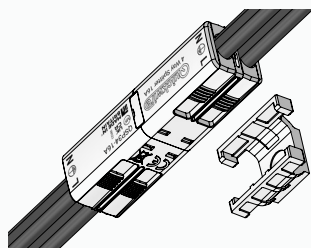

### CABLE REMOVAL

Mount removal tool (part no. QRT). Place thumb on thumb grip and using other hand, squeeze side arms so they locate beneath the snaps. Push forward.

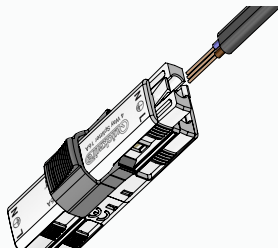

Patent no. PCT/GB2016/053627  
Reg.Design. 6004582

This product is designed for lighting installations only. Overcurrent protection is limited to 16A max. **Circuit to be protected by 16A MCB max.**

This product should be installed by a qualified electrician, ensuring the installation complies to the current IET wiring regulations. Switch off mains supply before commencing any electrical work.



+44 (0)1183 840025 | [Info@quickwire.co.uk](mailto:Info@quickwire.co.uk) | [www.quickwire.co.uk](http://www.quickwire.co.uk)

Quickwire Limited, Ruscombe Business Park, Ruscombe Lane, Twyford, Berkshire RG10 9JW, UK

A flexconnectors Company



# T-Connector Plug & Socket

**16A**

Socket: 2x 1mm<sup>2</sup>/1.5mm<sup>2</sup> T&E solid core  
Plug: 1x Flexible (Class 5/6 conductors)

- Lightning fast Quickwire™ push in technology
- Easy disconnection for maintenance and testing.
- Pre-flexed plug options available.
- Compact - Fits through 30mm hole.



	Socket	Plug
PART NUMBER	QTPS3	
RATING	250V~ 16A (Overcurrent protection limited to 16A)	
POLES	3 - pole	
CABLE ENTRY	2 x 1.0mm <sup>2</sup> – 1.5mm <sup>2</sup> Twin & Earth CPC Cable (6242Y or 6242B), Solid cores (Class 1)	1 x Flexible (Class 5/6 conductors) or 1 x Rigid (Class 1 conductors)
CONDUCTOR SIZE	1.0mm <sup>2</sup> – 1.5mm <sup>2</sup> Twin & Earth CPC Cable (6242Y or 6242B), Solid cores (Class 1)	0.5mm <sup>2</sup> – 1.5mm <sup>2</sup>
DIMENSIONS	23mm x 24mm x 60mm (fits through a 30mmØ hole)	
IP RATING	IP30	IP20 (When plugged in)

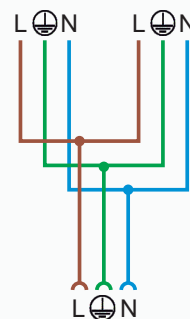

## CABLE PREPARATION

Cut and strip the 1.0mm<sup>2</sup> / 1.5mm<sup>2</sup> solid core, flat twin and earth cable as shown below:

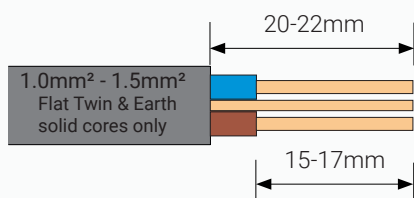

## INSTALLATION

1. Align prepared cable and guide into outlet, until resistance is met. At this stage check sheath is within cord grip (A) and conductors are visible through windows (B).

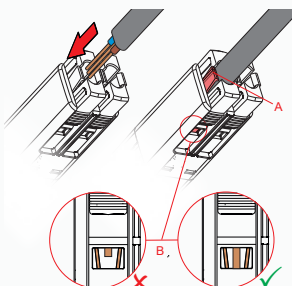

2. Continue to push cable until shuttle snaps into place (A). Repeat process for other outlet or push in unused shuttle.

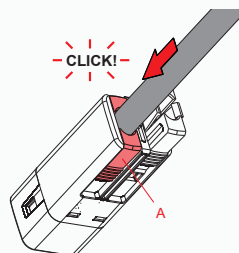

1. After cable termination, close just cover side which includes cord grip (A), then push cable firmly into cord grip (B).

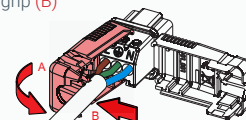

Bring other cover side around to meet and press both halves together until they click (C). Check both latches have engaged.

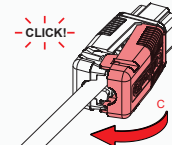

## CABLE REMOVAL

Mount removal tool (part no. QRT). Place thumb on thumb grip and using other hand, squeeze side arms so they locate beneath the snaps. Push forward.

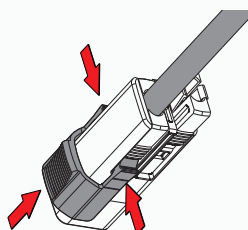

Patent no. PCT/GB2016/053627  
Reg.Design. 6004582

This product is designed for lighting installations only.  
Overcurrent protection is limited to 16A max.  
**Circuit to be protected by 16A MCB max.**

This product should be installed by a qualified electrician, ensuring the installation complies to the current IET wiring regulations. Switch off mains supply before commencing any electrical work.



+44 (0)1183 840025 | [Info@quickwire.co.uk](mailto:Info@quickwire.co.uk) | [www.quickwire.co.uk](http://www.quickwire.co.uk)

Quickwire Limited, Ruscombe Business Park, Ruscombe Lane, Twyford, Berkshire RG10 9JW, UK

A flexconnectors Company

# Quickwire

## 2 Way Splitter 24A

To fit 2.5mm<sup>2</sup>  
Twin & Earth solid core cable

- Lightning fast Quickwire™ push in technology.
- Maintenance free.
- Compact - Fits through 24mm hole.
- No earth sleeving required.
- Break into ring final circuits.
- Repair or extend existing cable runs.



PART NUMBER	QSP32_24A	
RATING	250V~ 24A	
CONDUCTOR SIZE	2.5mm <sup>2</sup> Twin & Earth CPC Cable (6242Y and 6242B) Solid cores (Class 1)	
DIMENSIONS	23mm x 16mm x 84mm	
IP RATING	IP30	
STANDARDS	BS EN 60670-22 BS 5733-MF	
MOUNTING CLAMP	Compatible with Quickwire mounting clamp: QMC_TB	

### CABLE PREPARATION

Cut and strip the 2.5mm<sup>2</sup> solid core, flat twin and earth cable as shown below:

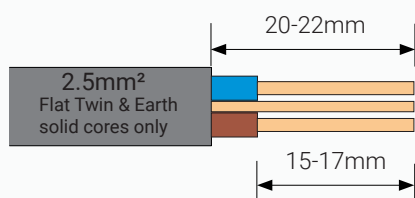

### INSTALLATION

Orientate and align pre-cut cable and insert into appropriate cable entry point. Each wire should guide itself into the correct terminal. Push cable until there is resistance.

Check there is a sufficient length of outer cable sheath available for clamping (fig.1) and that an unbroken length of conductor occupies the full extent of the window (fig.2).

Push cable until it snaps into place. Repeat process for additional cables. Push in any unused cable entries.

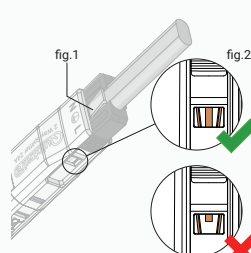
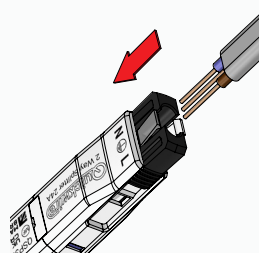

### SURFACE MOUNTING

If required the Quickwire can be fitted onto a surface using the Quickwire mounting clip. (Part no. QMC\_TB). **Warning: Do not cover**

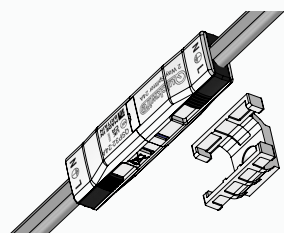

### CABLE REMOVAL

Mount removal tool (part no. QRT). Place thumb on thumb grip and using other hand, squeeze side arms so they locate beneath the snaps. Push forward.

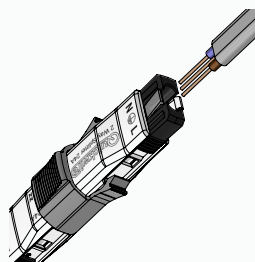

Patent no. PCT/GB2016/053627  
Reg.Design. 6004582

This product should be installed by a qualified electrician, ensuring the installation complies to the current IET wiring regulations. Switch off mains supply before commencing any electrical work.



+44 (0)1183 840025 | [Info@quickwire.co.uk](mailto:Info@quickwire.co.uk) | [www.quickwire.co.uk](http://www.quickwire.co.uk)

Quickwire Limited, Ruscombe Business Park, Ruscombe Lane, Twyford, Berkshire RG10 9JW, UK

A flexconnectors Company



# Quickwire

## 4 Way Splitter 24A

To fit 2.5mm<sup>2</sup>  
Twin & Earth solid core cable

- Lightning fast Quickwire™ push in technology
- Maintenance free.
- Compact - Fits through 30mm hole.
- No earth sleeving required
- Extend and distribute power circuits
- Allows connection of two spurs



PART NUMBER	QSP34_24A	
RATING	250V~ 24A	
CONDUCTOR SIZE	2.5mm² Twin & Earth CPC Cable (6242Y and 6242B) Solid cores (Class 1)	
DIMENSIONS	23mm x 24mm x 84mm	
IP RATING	IP30	
STANDARDS	BS EN 60670-22 BS 5733-MF	
MOUNTING CLAMP	Compatible with Quickwire mounting clamp: QMC_TB	

### CABLE PREPARATION

Cut and strip the 2.5mm<sup>2</sup> solid core, flat twin and earth cable as shown below:

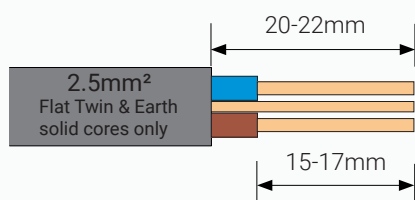

### INSTALLATION

Orientate and align pre-cut cable and insert into appropriate cable entry point. Each wire should guide itself into the correct terminal. Push cable until there is resistance.

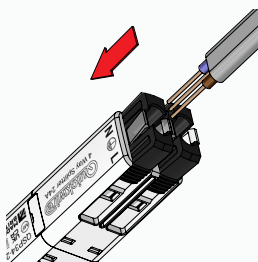

Check there is a sufficient length of outer cable sheath available for clamping (fig.1) and that an unbroken length of conductor occupies the full extent of the window (fig.2).

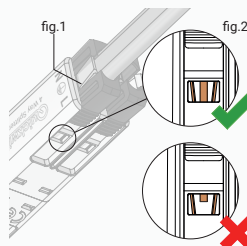

Push cable until it snaps into place. Repeat process for additional cables. Push in any unused cable entries.

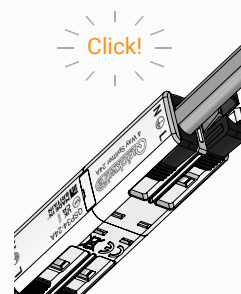

### SURFACE MOUNTING

If required the Quickwire can be fitted onto a surface using the Quickwire mounting clip. (Part no. QMC\_TB). **Warning: Do not cover**

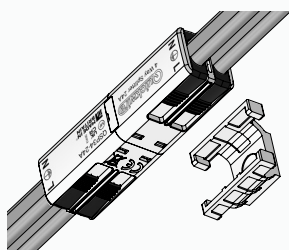

### CABLE REMOVAL

Mount removal tool (part no. QRT). Place thumb on thumb grip and using other hand, squeeze side arms so they locate beneath the snaps. Push forward.

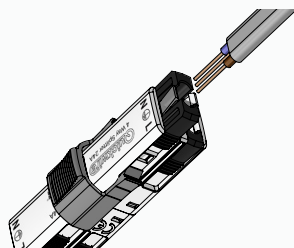

Patent no. PCT/GB2016/053627  
Reg.Design. 6004582

This product should be installed by a qualified electrician, ensuring the installation complies to the current IET wiring regulations. Switch off mains supply before commencing any electrical work.



+44 (0)1183 840025 | [Info@quickwire.co.uk](mailto:Info@quickwire.co.uk) | [www.quickwire.co.uk](http://www.quickwire.co.uk)

Quickwire Limited, Ruscombe Business Park, Ruscombe Lane, Twyford, Berkshire RG10 9JW, UK

A flexconnectors Company