

Quickwire

4 Way Splitter 24A

To fit 2.5mm²
Twin & Earth solid core cable

- Lightning fast Quickwire™ push in technology
- Maintenance free.
- Compact - Fits through 30mm hole.
- No earth sleeving required
- Extend and distribute power circuits
- Allows connection of two spurs



PART NUMBER	QSP34_24A	
RATING	250V~ 24A	
CONDUCTOR SIZE	2.5mm ² Twin & Earth CPC Cable (6242Y and 6242B) Solid cores (Class 1)	
DIMENSIONS	23mm x 24mm x 84mm	
IP RATING	IP30	
STANDARDS	BS EN 60670-22 BS 5733-MF	
MOUNTING CLAMP	Compatible with Quickwire mounting clamp: QMC_TB	

CABLE PREPARATION

Cut and strip the 2.5mm² solid core, flat twin and earth cable as shown below:

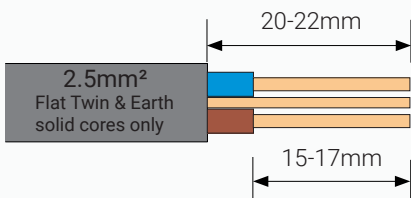

INSTALLATION

Orientate and align pre-cut cable and insert into appropriate cable entry point. Each wire should guide itself into the correct terminal. Push cable until there is resistance.

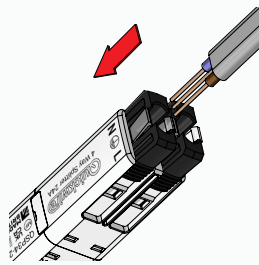

Check there is a sufficient length of outer cable sheath available for clamping (fig.1) and that an unbroken length of conductor occupies the full extent of the window (fig.2).

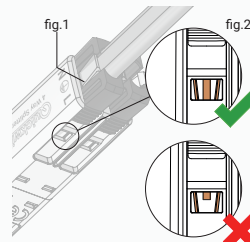

Push cable until it snaps into place. Repeat process for additional cables. Push in any unused cable entries.



SURFACE MOUNTING

If required the Quickwire can be fitted onto a surface using the Quickwire mounting clip. (Part no. QMC_TB). **Warning: Do not cover**

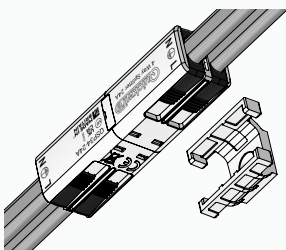

CABLE REMOVAL

Mount removal tool (part no. QRT). Place thumb on thumb grip and using other hand, squeeze side arms so they locate beneath the snaps. Push forward.

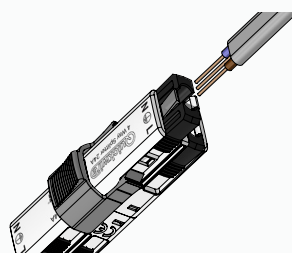

Patent no. PCT/GB2016/053627
Reg.Design. 6004582

This product should be installed by a qualified electrician, ensuring the installation complies to the current IET wiring regulations. Switch off mains supply before commencing any electrical work.



+44 (0)1183 840025 | Info@quickwire.co.uk | www.quickwire.co.uk

Quickwire Limited, Ruscombe Business Park, Ruscombe Lane, Twyford, Berkshire RG10 9JW, UK

A flexconnectors Company